

**U.S. Army Corps of Engineers
Fiscal Year 2024
Handshake Program Application**

Please review instructions before completing application!

Corps Lake/River Project Name: **Burnsville Lake**

District / Division: **Huntington District/LRD**

Handshake Proposal Title: **Falls Mill All Access Paddle Craft Launch Ramp**

Corps POC Name: **Brian Carson**

Telephone: **(304) 853 - 2371** ext.

E-Mail: **james.b.carson@usace.army.mil**

A. Checklist:

1. Will the Handshake funds be spent on Corps facilities and resources that are being fully maintained by the Corps? (not in outgranted parks) Yes No
 2. Will the Challenge Partnership agreement be with a non-federal public or private entity(ies)? Yes No
 3. Is the proposed activity within current authorities and contained in the annual or 5-year work plan in the approved lake project OMP? Yes No
 4. Have all of the NEPA requirements been considered for this project? Yes No
 5. I am aware the Challenge Partnership Agreement must be reviewed and approved by District Office of Counsel before sending to HQUSACE. Yes No
 6. If the full funding amount requested is not available, could a portion of this Handshake Project be completed with partial funding? Yes No
 7. I am aware that all government funds must be spent in accordance with FAR, DFAR and AFAR contracting laws and regulations, and that Handshake funds cannot be provided to the partner(s). Yes No
 8. Did you participate in a Handshake webinar in 2023 or review a 2023 Handshake webinar on the Gateway? Yes No
-

B. Handshake Funding Request (maximum \$25,000): 25,000

C. Corps Foundation Bonus Request: (maximum \$5,000): 5,000

Separate bonus funding provided by the Corps Foundation for a selected Handshake Project. Please do not include bonus funds on your overall financial spreadsheet below. Provide an explanation of how the funds will be used in the Corps Foundation Bonus section.

D. Incentive Points Category: Check the appropriate box if your application qualifies to receive bonus points on the evaluation score.

This lake/river project has never received Handshake funding. (100pts)

This lake/river project has not received Handshake funding in the past 5 years (FY 19-23 funding years). (50 pts)

This partnership project will either result in overall O&M cost savings or no net long-term O&M gain. It reduces program liabilities, consolidates or eliminates redundant/inefficient recreation assets or facilities (Up to 200 pts)

E. Describe your partnership and the proposed Handshake Partnership Project:

Project applications will be evaluated on the categories below. Please complete each section as appropriate.

Summary Statement:

The Falls Mill All Access Paddle Craft Launch Project is to promote outdoor recreation for everyone, regardless of age, strength, or physical ability. The main focus of this project is to add an ADA accessible paddle craft launch to Burnsville Lake. This would be a one-of-a-kind attraction for Central West Virginia. The Falls Mill All Access Paddle Craft Launch Project would take place at the beautiful head waters of Burnsville Lake, which is the location of the beautiful Falls Mill. This would provide a safe and peaceful location for everyone to enjoy spending time in nature on paddle crafts.

Handshake Funding Cost Break Down:

This Handshake Partnership project funds will support development of a accessible paddlecraft launch facility at the Falls Mill Recreation Area. The handshake funds will be allocated for the following costs of materials associated with the accessible paddle craft launch.

ADA Paddle Craft Launch Materials (Gangway, handrails, floating platform, kayak roller system, ADA bench, and shipping) \$46,756.76

Stone for ground stabilization - \$1,520

Signs - \$1,500

Concrete for walkway \$3,500

Total: \$53,276.76

O&M Impacts:

The Falls Mill All Access Paddle Craft Launch Project will add a much-needed access to Burnsville Lake, without an increase to the reoccurring O&M costs due to partnership commitment of operations and maintenance. The EZDock EZ Launch System is designed to be versatile, environmentally friendly using a pioneered design that is durable and low maintenance. The EZ Dock is made from polyethylene that will not rot, splinter, or require routine maintenance. The dock uses rubber couplings that allows it to be flexible to all environmental conditions. The area will also get a new concrete walkway to allow for easy access to the water without continuous upkeep to a gravel path. The project will be finished off with three ADA accessible picnic sites located along the walkway that will provide for a nice resting spot before or after a relaxing trip on the lake. A big part of the local Corps office funds that will be used for this project is America the Beautiful Pass funds that our project has received from selling AtB passes. The project meets the criteria for use of the AtB funds by providing visitor access, visitor needs assessment and enhancement of the recreation area. The Friends of Burnsville Lake has committed to the responsibility of short/long term operations and maintenance of the new facility and future improvements to the launch facility. This results in no net gain to the projects O&M of Falls Mill Recreation Area.

Partnership Value:

The Friends of Burnsville Lake is a long-standing partner here at Burnsville Lake, which is in the process of switching over to a Cooperating Association to provide more partnering opportunities for the lake. The partner has been committed to Burnsville Lake and the community for over 15 years, providing many improvements and services to the visitors. For the Falls Mill All Access Paddle Craft Launch Project, the Friends of Burnsville Lake has pledged to contribute \$12,500 in funding to make this project come to life and continue their support by maintaining facility. This group also has partnered with the Little Kanawha River Trail to jointly lobby for future access points on the Little Kanawha River. The Little Kanawha River Trail group has committed volunteer efforts to the project along with becoming an engaged partner of USACE and the Friends group at Burnsville Lake. This river access project will add a major attraction point for the river trail system, allowing paddle crafters to enjoy

Burnsville Lake from the headwaters to the dam. Once the launch is completed, the Friends of Burnsville Lake will make sure that this launch stays in good condition for years to come. Providing opportunities like this will keep the partner and community engaged, along with leveraging more community members to become partners or become involved with our current partners.

Recreational Value:

The project will promote the recreational experience to all age groups and offer the opportunity to safely launch their paddle craft in one of the most scenic areas of the lake. The Falls Mill All Access Paddle Craft Launch Project will be a huge improvement for water access for visitors at Burnsville Lake. The increased trends in paddle craft use over the past five years has led to the need for paddle craft launch areas. This launch facility has features that will be unique to Central West Virginia and will provide an opportunity to paddle craft users of all types and abilities. This paddle craft launch is designed for those folks that have a disability, or limitations that make using paddle crafts a challenge. When we started looking at this project, we wanted something that would provide a benefit to an array of users, novice to expert, and all ages and ability. The accessible paddle craft ramp will open more opportunities for all individuals to interact with the park's natural resources and promote outdoor family gatherings, regardless of physical abilities. We want to give a safe opportunity for visitors of all ages, and those with physical limitations a way to enjoy a relaxing day on Burnsville Lake. This will be added to enhance visitation to the Falls Mill Recreation Area. There is no better way to relax than on paddle craft in the Falls Mill Area of Burnsville Lake!

Environmental Stewardship Value:

The EZ Dock system is made completely from environmentally friendly materials. The dock parts are made from a polyethylene that does not require foam that could cause environmental hazards if punctured. If for some reason something happened to the dock, every bit of the dock can be recycled. All the parts are made so they do not corrode and cannot release toxins if ignited or through chemical reactions. The rubber couplers are made from 90% recycled rubber and have been proven to be environmentally friendly. No more using wood that could have been treated with a CCA product and no bulky foam floats that can deteriorate and be dangerous to wildlife habitat. This launch will also stop erosion that is caused by visitors dragging their gear up and down the riverbanks to access the water from various points. The EZ Dock system has streamlined the industry for paddle craft launch ramps. We will also be adding rip rap stone to enhance shoreline stabilization around the launch facility.

Communication & Education Value:

One of the major missions that USACE has is the importance of water safety. Here at Burnsville Lake, we take water safety seriously. This is one of the main reasons that we want to see this all-access paddle craft launch installed. Many people immediately think of safety concerns when they hear the word kayak or canoe. What will I do if I flip trying to get in or out of my kayak? I'm too old to climb up and down that bank. How do you expect me to get in that thing? These are just a few examples of the importance of a safe paddle craft launch facility. With a state-of-the-art paddle craft launch, the number of risk factors that occur while getting in and out of a paddle craft are decreased significantly. Through partnering with the Friends of Burnsville Lake and the Little Kanawha River Trail, we would like to offer scenic kayak trips through the historic Falls Mill and Bulltown Areas. We would also like to start a paddle craft safety day that would be held at the new all access paddle craft launch. This project has limitless opportunities to get folks with all different backgrounds out and enjoying nature. Various kiosks will include the proper techniques of paddling, water safety messages, maps and photos of flora and wildlife living along the river trail, and history of the Little Kanawha River Trail. We will also incorporate a life jacket loaner station.

Supporting Diversity, Equity, Inclusion, and Access Goals:

The Falls Mill All Access Paddle Craft Launch would be the only all-inclusive paddle craft launch facility in Central West Virginia. The paddle craft launch uses a transfer bench system to allow people with disabilities, children, or seniors to feel comfortable transferring into their watercraft independently. The raised curbing and handrails provide a safe border for wheelchairs. This project allows for a much needed all access launch facility for visitors of all backgrounds to feel safe recreating on public lands.

Corps Foundation Bonus Cost Break Down:

The Corps Foundation funds will be used to purchase additional interpretive signs depicting the Little Kanawha River Trail History, showcasing flora and wildlife that thrive along the river trail and water safety education. The funds would also be used to add a concrete walkway to provide accessibility to picnic tables and grills to the existing recreation area. The additional work would help forge new partnerships and strengthen the relationship with the Little Kanawha River Trail organization and community.

Picnic table materials (Frame, lumber, and hardware) \$1,050

Outdoor cooker grills - \$700

Concrete Walkway -\$1,500

Interpretative Signs - \$1,750

Total \$5,000

Conclusion:

Burnsville Lake and its partners are committed to providing the All Access Paddle Craft Launch and with the handshake funds, USACE and its partners can make this possible. A top-tier ADA compliant paddle craft launch ramp is needed in our area, and through this project, that need can be fulfilled. For anyone that enjoys a relaxing day on the lake, to people that are just getting interested in the sport of paddle crafting, this will provide safe access to Burnsville Lake for all.

NOTE: To show foresight, commitment, and planning, it is REQUIRED to include maps/pictures/plans/specs as part of your overall package. Failure to include supporting attachments will result in points deductions.

Double click on spreadsheet to access data entry fields and to enter Partner names.

You MUST enter partner names into the spreadsheet:

	Local Corps Office	Handshake Funds	Friends of Burnsville Lake	Little Kanawha Trail	Partner 3	Partner 4
Salaries	\$7,591	N/A	\$0	\$0	\$0	\$0
Travel	\$0	N/A	\$0	\$0	\$0	\$0
Materials and Supplies	\$15,777	\$25,000	\$12,500	\$0	\$0	\$0
Equipment Use	\$1,440	\$0	\$0	\$0	\$0	\$0
Funds Contributed	N/A	N/A	\$0	\$0	\$0	\$0
Personal Property	N/A	N/A	\$0	\$0	\$0	\$0
Volunteer	N/A	N/A	\$4,770	\$2,750	\$0	\$0
In-Kind Services	N/A	N/A	\$0	\$0	\$0	\$0
Other (explain below)	\$0	\$0	\$0	\$0	\$0	\$0
Total	\$24,808	\$25,000	\$17,270	\$2,750	\$0	\$0
Share of Total Cost	35.5%	35.8%	24.7%	3.9%	0.0%	0.0%
	71.3%					

	Partner 5	Partner 6	Partner 7	Partner 8	Partner 9	Partner 10
Salaries	\$0	\$0	\$0	\$0	\$0	\$0
Travel	\$0	\$0	\$0	\$0	\$0	\$0
Materials and Supplies	\$0	\$0	\$0	\$0	\$0	\$0
Equipment Use	\$0	\$0	\$0	\$0	\$0	\$0
Funds Contributed	\$0	\$0	\$0	\$0	\$0	\$0
Personal Property	\$0	\$0	\$0	\$0	\$0	\$0
Volunteer	\$0	\$0	\$0	\$0	\$0	\$0
In-Kind Services	\$0	\$0	\$0	\$0	\$0	\$0
Other (explain below)	\$0	\$0	\$0	\$0	\$0	\$0
Total	\$0	\$0	\$0	\$0	\$0	\$0
Share of Total Cost	0.0%	0.0%	0.0%	0.0%	0.0%	0

	Partner 11	Partner 12	Partner 13	Partner 14	Partner 15	Total
Salaries	\$0	\$0	\$0	\$0	\$0	\$7,591
Travel	\$0	\$0	\$0	\$0	\$0	\$0
Materials and Supplies	\$0	\$0	\$0	\$0	\$0	\$53,277
Equipment Use	\$0	\$0	\$0	\$0	\$0	\$1,440
Funds Contributed	\$0	\$0	\$0	\$0	\$0	\$0
Personal Property	\$0	\$0	\$0	\$0	\$0	\$0
Volunteer	\$0	\$0	\$0	\$0	\$0	\$7,520
In-Kind Services	\$0	\$0	\$0	\$0	\$0	\$0
Other (explain below)	\$0	\$0	\$0	\$0	\$0	\$0
Total	\$0	\$0	\$0	\$0	\$0	\$69,828
Share of Total Cost	0.0%	0.0%	0.0%	0.0%	0.0%	100%

Explanations:

Local Corps Office – The money for this project from the local corps office is \$7,591 for labor 120-man hours at \$63.26 per hour, \$15,777 in materials (ATB funds will be used to purchase materials), \$1,440 for equipment use (our project owns the equipment, but these are local hourly rental rates).

Handshake Funds – The Handshake Funds for this project will be used to assist with purchasing the EZ Dock Paddle Craft Launch.

Friends of Burnsville Lake – The Friends of Burnsville Lake will be providing \$12,500 to go towards purchasing materials for the Paddle Craft Launch Ramp. The Friends of Burnsville Lake will also be providing 150 hours of volunteer service at a value of \$4,770.

Little Kanawha River Trail Association – will provide volunteer labor to assist in the installation of the EZ Dock Paddle Craft Launch facility and associated components.

EZ Dock EZ Launch Drive Through ADA Paddle Craft Launch Ramp

<https://www.ez-dock.com/product/ez-launch-drive-through-ada/>

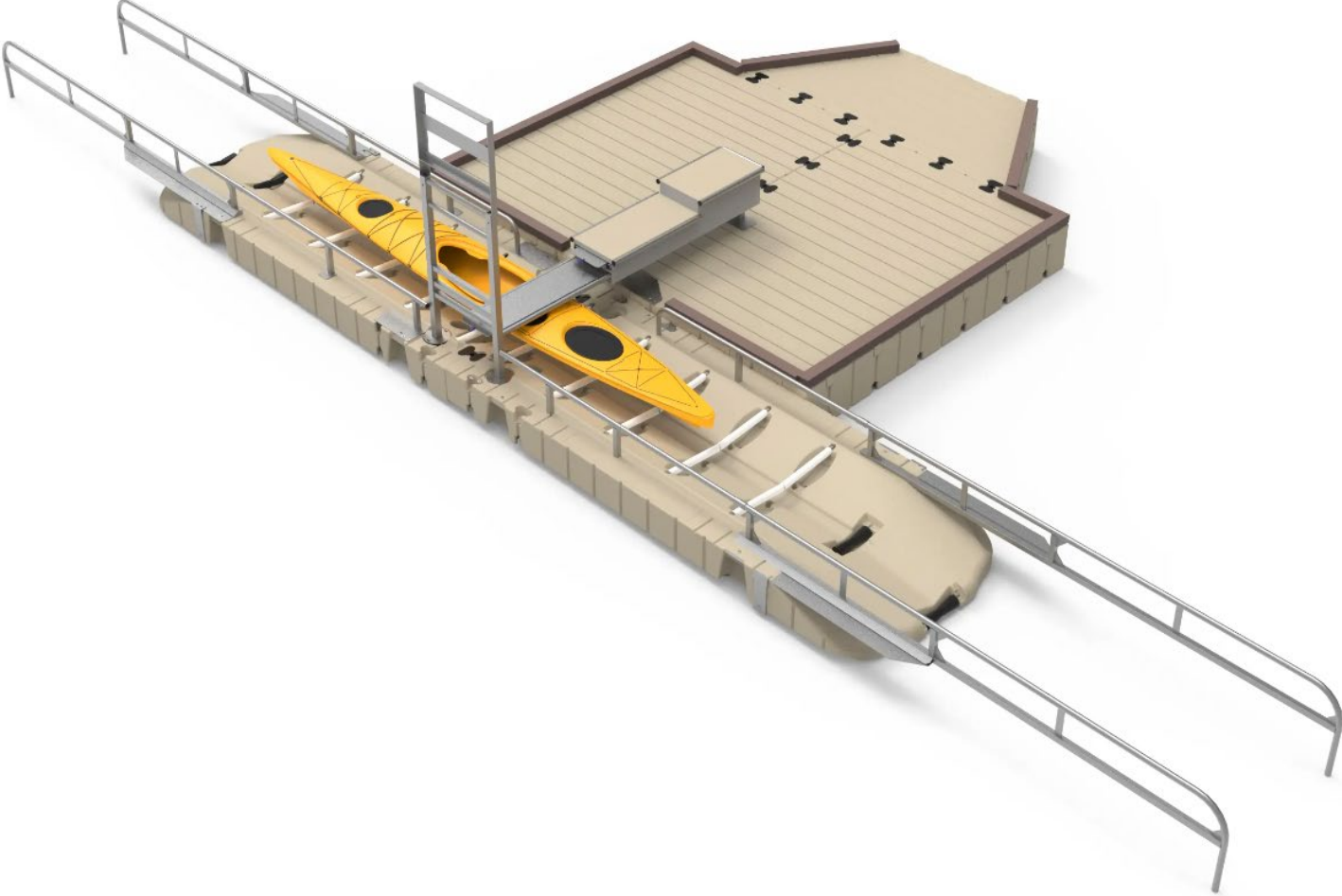

Falls Mill All Access Paddle Craft Launch Ramp Drawing

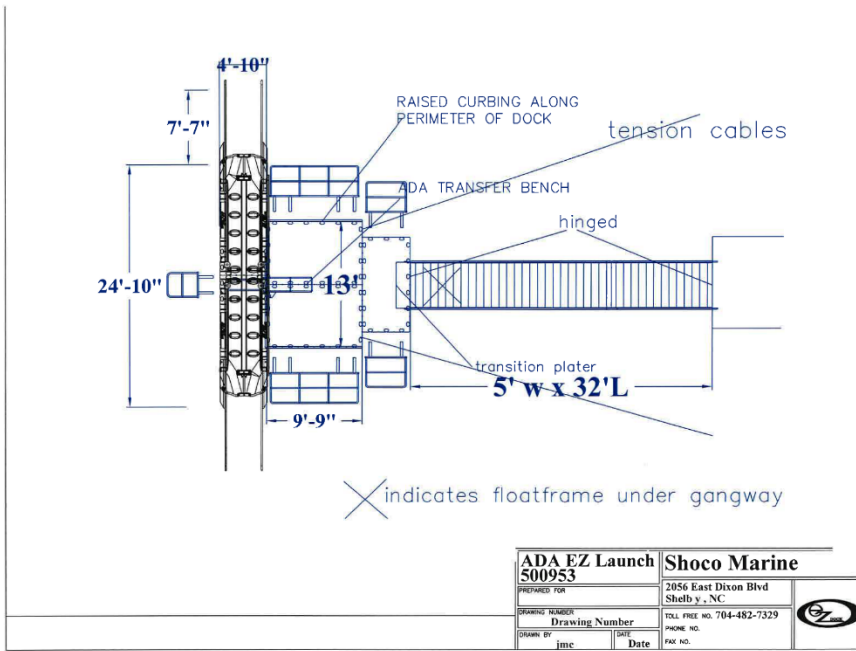

Transfer bench and handrail allows for easier access for those with accessibility issues



Falls Mill Area Map



Overview of location



Detailed Falls Mill All Access Paddle Craft Launch Site Map

